

# L SERIES - 180 HEAD SPARE PARTS DIAGRAM

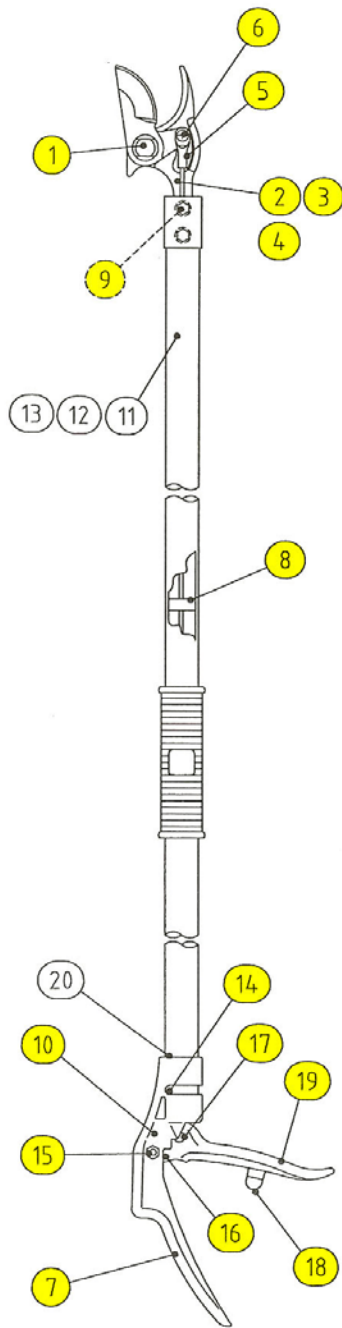

- |     |          |   |
|-----|----------|---|
| 1.  | SP-LA216 | Pivot Bolt for Blade Set  |
| 2.  | SP-LA236 | Rod Set for LA-180L12   |
|     |          | (includes end cylinder and rod end cap)   |
| 3.  | SP-LA237 | Rod Set for LA-180L18   |
|     |          | (includes end cylinder and rod end cap)   |
| 4.  | SP-LA238 | Rod Set for LA-180L21   |
|     |          | (includes end cylinder and rod End Cap)   |
| 5.  | SP-LA264 | Rod End Cap (Bolt with loop to attach blade to rod)   |
| 6.  | SP-LA259 | Screw Set (attaches blade to rod)   |
| 7.  | SP-LA79  | Complete Handle Set (includes spring, latch lock set, pivot bolt, shock absorber, grip lever, stop screw, sleeve for grip, and grip handle) |
| 8.  | SP-LA235 | Rod Holding Disc  |
| 9.  | SP-LA239 | Bolt with Nut (attaches blade to pipe)  |
| 10. | SP-LA101 | Spring for Handle   |
| 11. | SP-LA290 | Pipe for LA-180L12 — <b>Special Order</b>   |
| 12. |          | Pipe for LA-180L18  |
| 13. | SP-LA292 | Pipe for LA-180L21 — <b>Special Order</b>   |
| 14. | SP-LA39  | Stop Screw for Handle   |
| 15. | SP-LA40  | Pivot Bolt for Handle   |
| 16. | SP-LA42  | Latch Lock Set for Handle   |
| 17. | SP-LA43  | End Cylinder for Rod  |
| 18. | SP-LAXRC | Shock Absorber for Handle   |
| 19. | SP-LA145 | Grip Lever Only for Handle  |
| 20. |          | Sleeve for Grip   |

## BLADE SETS:

- |          |                       |
|----------|-----------------------|
| SP-180L1 | Replacement Blade Set |
|----------|-----------------------|

*All highlighted items are available from inventory.  
All others are available by Special Order.*